

 **ULTRA**FRAME

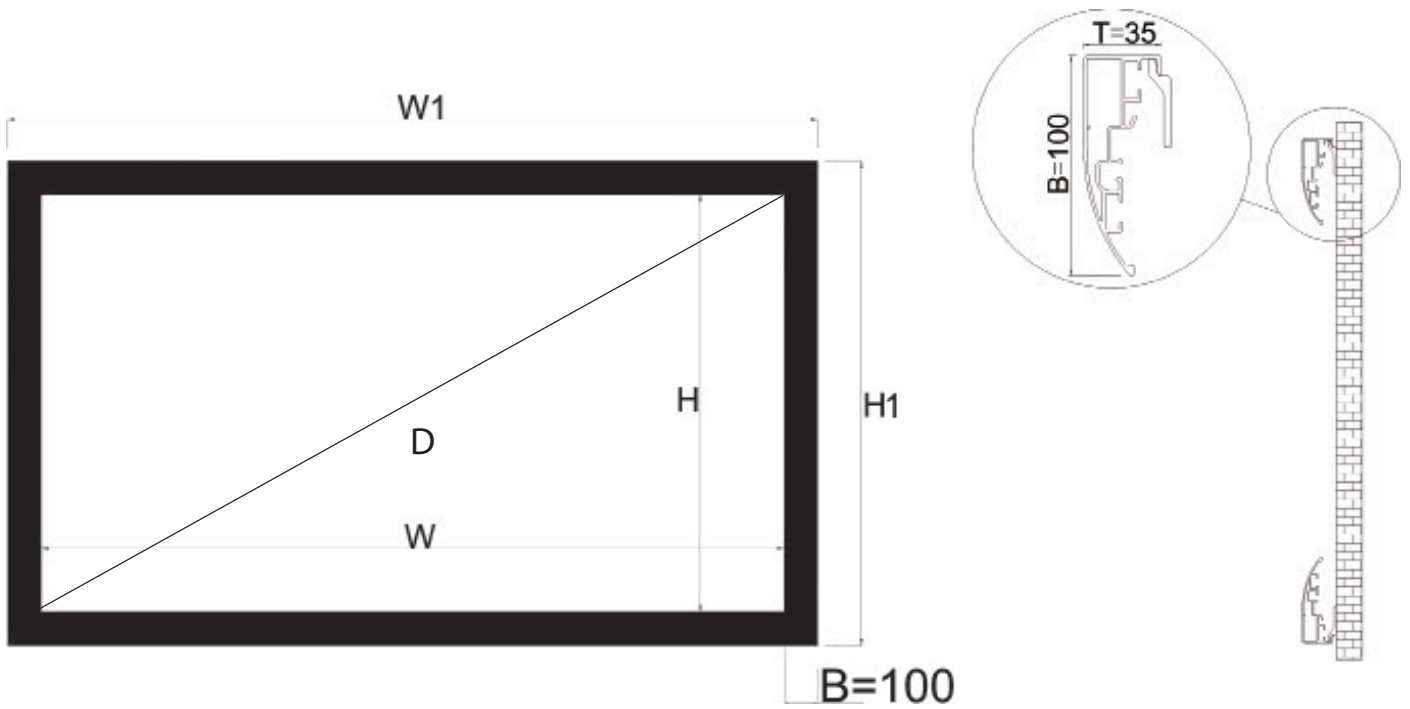

INSTALLATION
INSTRUCTIONS

GENERAL INFORMATION



Description	Diagonal Size (Inch)	W (cm)	H (cm)	Gross Weight	Packing Size		
					Length(cm)	W(cm)	H(cm)
Frames 16:9	92"	204	115	13,5	170	22	17
	100"	221	124	14,5	175	22	17
	109"	240	135	15	180	22	17
	120"	265	149	15,5	185	22	17
	129"	285	161	16,5	192	22	17
	145"	321	181	18	213	22	17
	150"	332	187	18,5	217	22	17
Frames 2.4:1	122"	286	119	15	189	22	17
	137"	321	134	18	211	22	17
	149"	350	146	19	217	22	17

INSTALLATION

ASSEMBLING THE FRAME

The long sides of the frame is divided into two parts. Please attach these first. Then attach the two short sides and tighten all corner screws. You might need to loosen and re-tighten some of the corners if required. A small gap will appear in each corner on the inside of the frame, caused by the velvet wrapping. This gap will not be visible on the front.

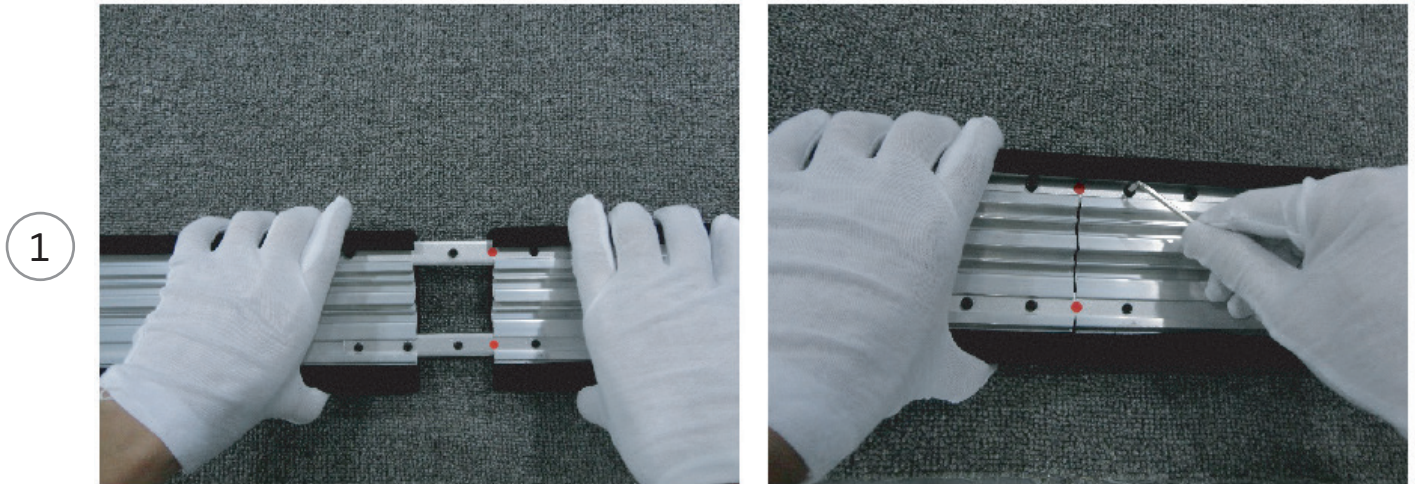

First, attach the long sections and secure them by tightening the screws.

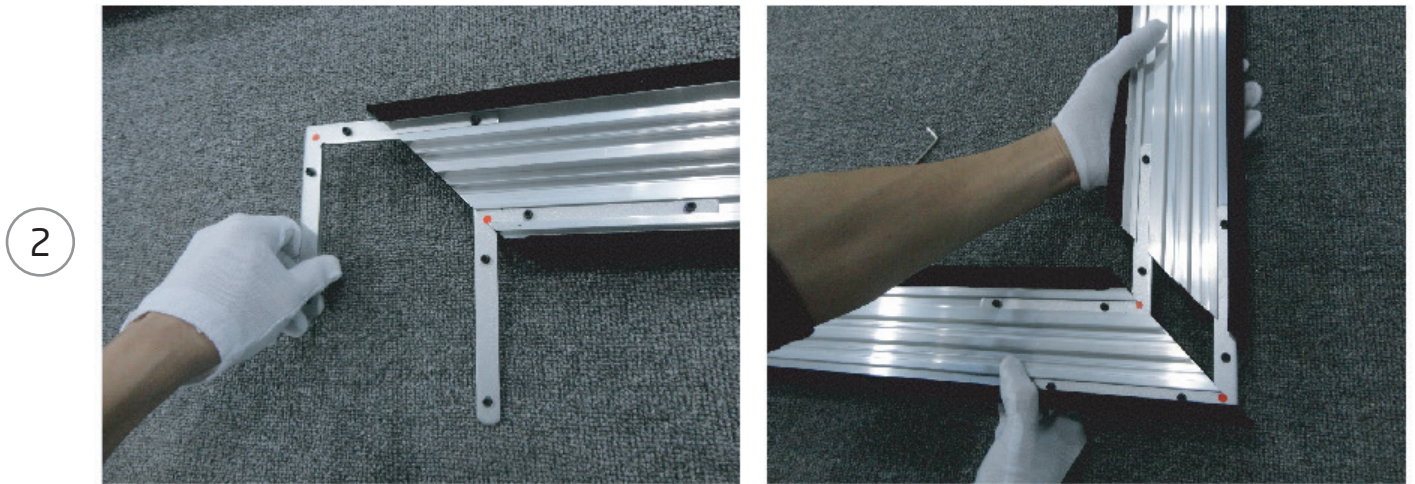

Then, attach the short sections and secure them by tightening the screws.

SUPPORT BAR FOR LARGER FRAMES

Larger frames includes a vertical support bar that is installed after the fabric is attached if you are using a PVC fabric. However, the bar needs to be in place before you install the UltraWeave fabric as you would otherwise not be able to attach it afterwards without risking pulling out the fabric from the grip rails. If you are placing speakers behind the screen, there is no problem moving the support bar 30-40cm towards one of the edges to avoid the bar conflicting with the center speakers.

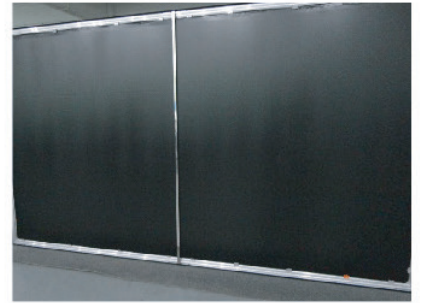
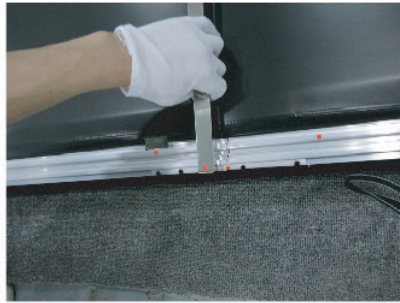
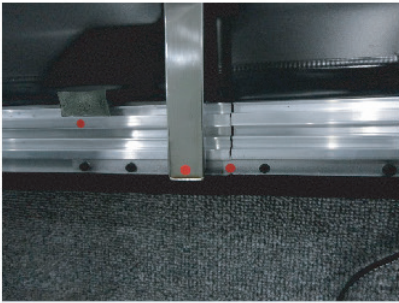

Slide the bar at an angle into the bottom, then slide it in on the top.



Work around the support bar by moving it back and forth a little if installing the UltraWeave fabric into grip rails.

INSTALLING THE ULTRAWEAVE AT FABRIC

If you have purchased the UltraWeave fabric to accommodate your screen, you will receive a set of grip rails that you can easily insert into the pre-fitted tracks of your UltraFrame. To tuck the fabric we recommend using a custom made tucking tool. If needed, you can easily pull up and re-tuck the fabric. For more detailed instructions, please visit our webpage.

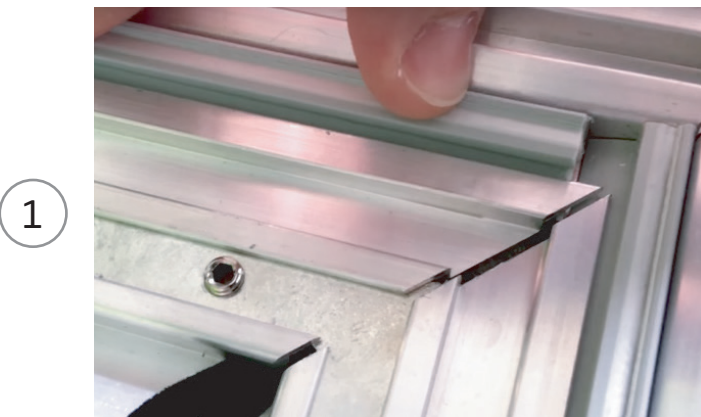

First, cut (use a regular cutting plier) the grip rails and insert them into the pre-fitted tracks. No glue is needed. Then place the fabric atop leaving the integrated, separate protective clothing underneath the frame and start tucking. **PS!** We recommend running the tucking tool through the rails first to open the slot as it is very tight from factory. This will make it far easier tucking the fabric afterwards.

2

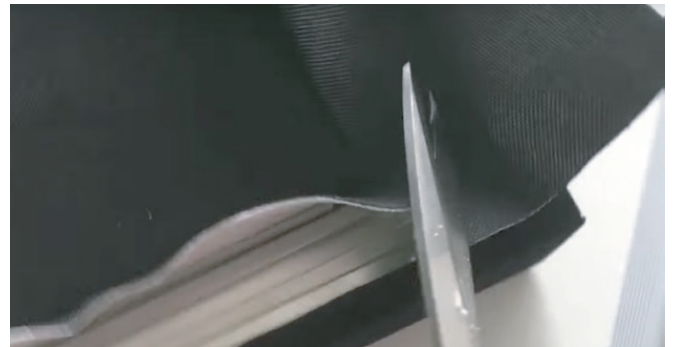

Start tucking in the fabric, long sides first, then the short sides. If needed, you can still easily pull out and re-tuck the fabric. When finished, cut of excessive fabric.

INSTALLING THE PVC FABRIC

If you have chosen to use the regular non-AT PVC materials, please follow these instructions.

1

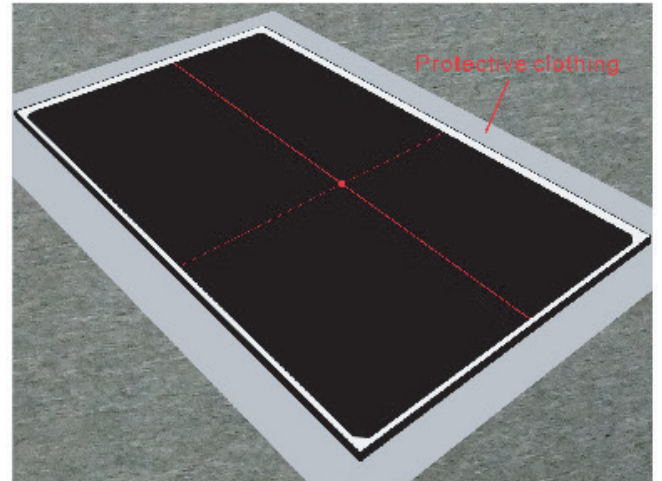

Remove the fabric and roll it out over the frame. Please use a protective clothing.

2

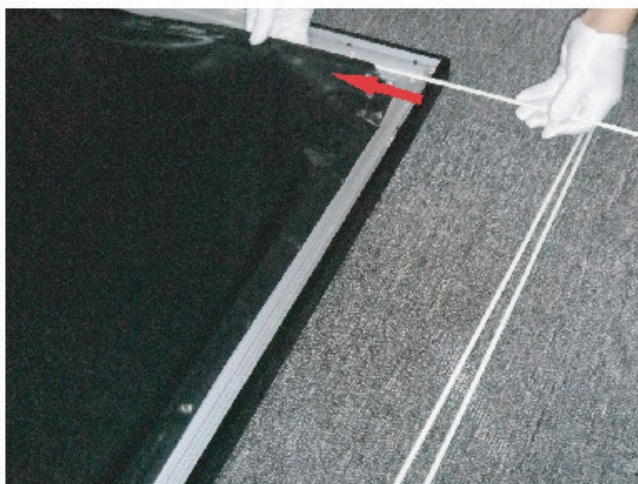

Tension rod (horizontal) x 4



Tension rod (vertical) x 2



Insert the horizontal and vertical tension rods.

INSTALLING THE PVC FABRIC

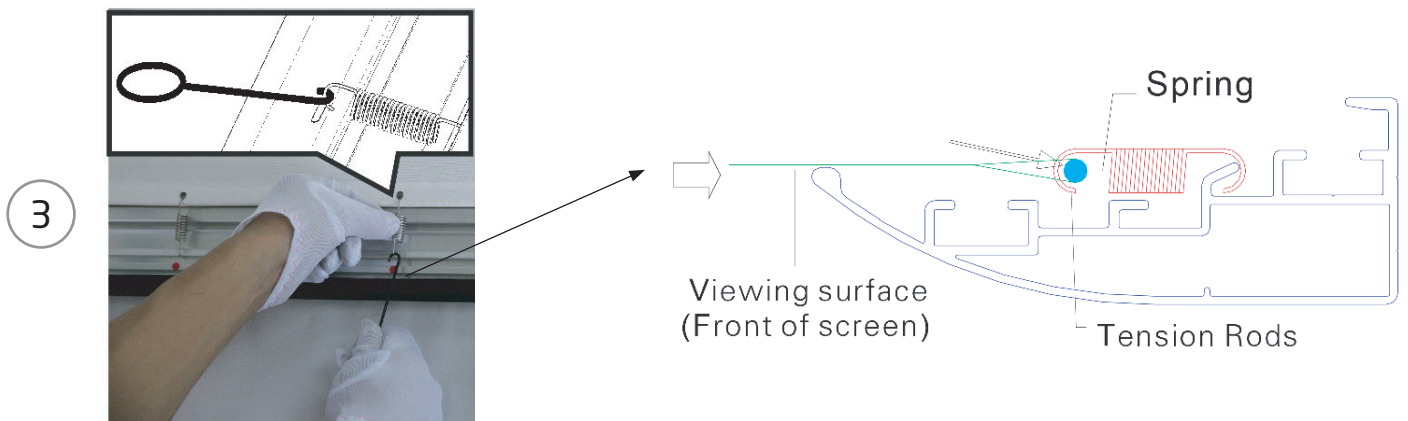

Pull the springs into the depicted groove.

WALL MOUNTING THE FRAME

The frame is easily mounted using only two top brackets. Make sure the brackets are leveled correctly and attach them to the wall using a fitting type of screw.

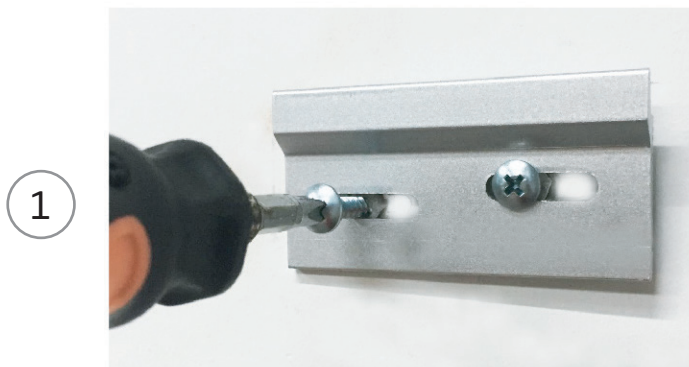

First, attach the two brackets to the wall. You can slide the frame so you are free to place the brackets as much as 20-40cm from the corners.

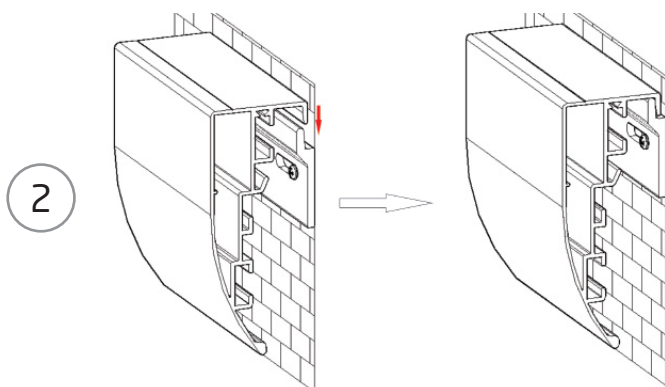

Then you simply hang the frame onto the two brackets and slide it into perfect position.